



9990

Fire Door Top Gap Solution — *Up To 90 Minutes*

PRODUCT CUT SHEET

**UL Certified for Door Top
Gaps — Measuring up to 1/2".**



- 90-Minute Rated — for Use on UL10B and UL10C Wood or Hollow Metal Fire Doors
- No Need to Move Hardware at the Top of the Door
- Works on Doors with Parallel Arm Closers
- Patent Pending
- Available in 36" and 48" Lengths
- Brushed Stainless Steel
- End Caps Furnished Standard
- Non-Handed

PRODUCT CONSISTS OF:

- + #304 Brushed Stainless Steel Flat Plate - Pull Side
- + #304 Brushed Stainless Steel Intumescent Cap — Push Side
- + #304 Brushed Stainless Steel End Caps
- + #6 X 3/4" Stainless Steel SMS Furnished

FINISH:

Brushed Stainless Steel

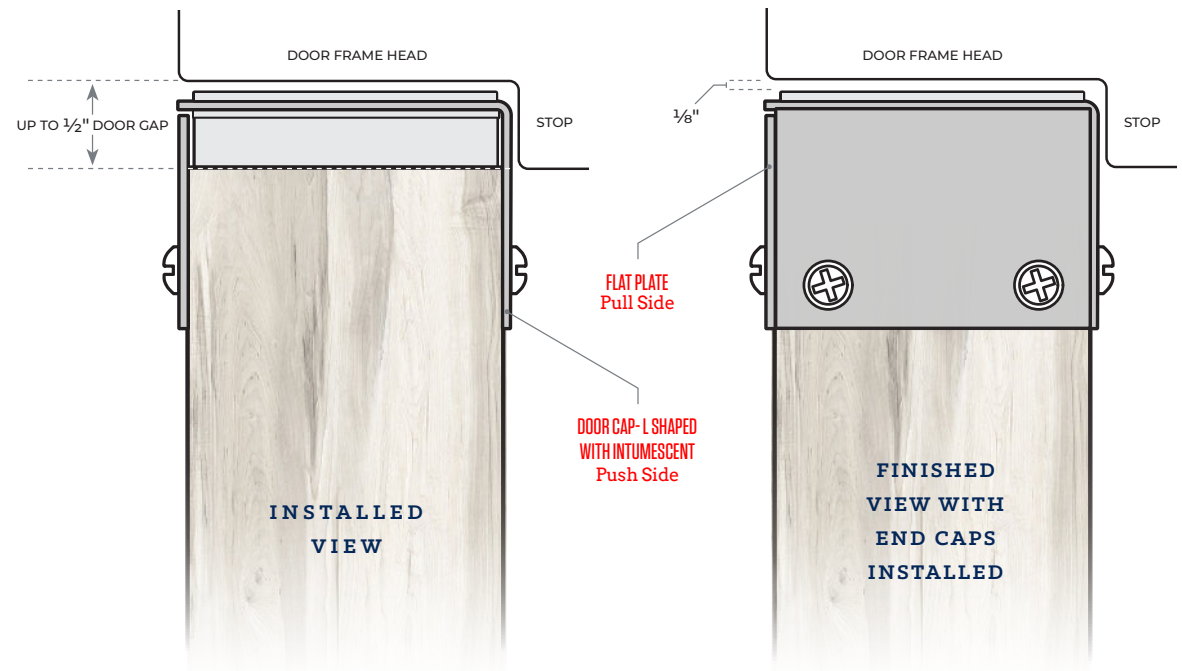

PROJECT:

SUBMITTED BY:

DATE:

NOTES:

NGP MEMPHIS
4985 East Raines Road
Memphis, TN 38118
orders@ngp.com

NGP VEGAS
4584 Calimesa Street
Las Vegas, NV 89115
vegasorders@ngp.com

NGP-FDA-GAP-PCS-0221-A

ngp.com
1-800-NGP-RUSH



9990

Intumescent Door Cap System

INSTALLATION INSTRUCTION

For the complete list of GapGuard™ Fire Door Accessories, the most up-to-date product information and installation instructions, scan the QR code or visit ngp.com.



For use on up to 90 minute UL10B and UL10C wood or hollow metal fire doors with clearance at head exceeding $\frac{1}{8}$ ", up to $\frac{1}{2}$ ".
UL certified for 90 minute fire doors with head clearance up to $\frac{1}{2}$ ".

Installation Instructions

L-Shaped Cap with Intumescent (Push Side Mount):

1. Cut to fit.
2. Prep for any top latching hardware (ie: Concealed Vertical Rod Exit Device latch or strike plate, or Automatic Flush Bolt) that is installed in accordance with manufacturer's installation instructions.
3. Close door. Hold at top of door with $\frac{1}{8}$ " clearance to frame header.
4. Mark screw holes.
5. Drill pilot holes for screws using a $\frac{7}{64}$ " drill bit.
6. Install with screws provided.
7. Adjust position for $\frac{1}{8}$ " clearance to frame header.

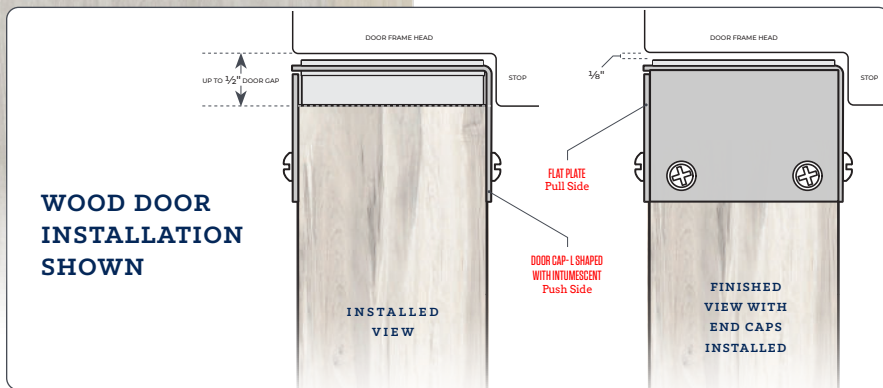

Straight Cap (Pull Side Mount):

1. Cut to fit.
2. Close door. Hold at top of door. Align top edge with top of L shaped cap.
3. Mark screw holes.
4. Drill pilot holes for screws using a $\frac{7}{64}$ " drill bit.
5. Install with screws provided.
6. Adjust to proper position.
7. Install end caps as illustrated.



POSITIVE PRESSURE TESTED
MISCELLANEOUS FIRE DOOR
ACCESSORY

6.21

NGP-GAP-9990-PRI-0621-A



NGP MEMPHIS
4985 East Raines Road
Memphis, TN 38118
orders@ngp.com

NGP VEGAS
4584 Calimesa Street
Las Vegas, NV 89115
vegasorders@ngp.com

ngp.com
1-800-NGP-RUSH